

6B

Steering Stem Upper Bracket Removal and Installation



[Reference: Steering Stem Components](#)

Removal

- 1) Support the motorcycle with a jack or wooden block.
- 2) Remove the air cleaner box.
- 3) Disconnect the ignition switch lead wire coupler (1) and immobilizer antenna lead wire coupler (2). (If equipped)

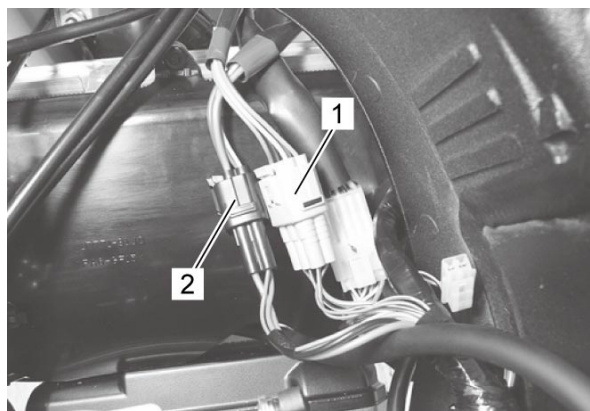

- 4) Disconnect the clamps (1).



- 5) Remove the guide (1).

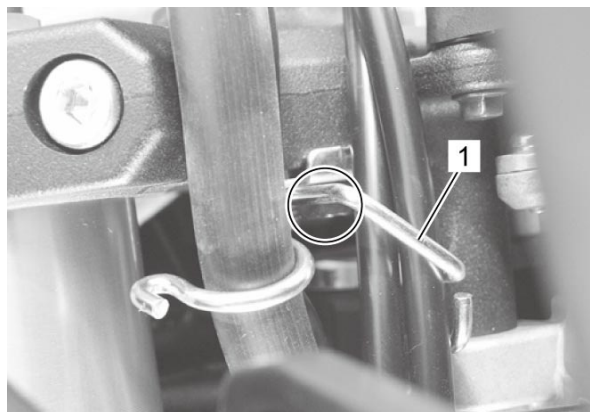

6) Remove the handlebar holders (1).

NOTE:

Slightly loosen the handlebar holder nuts (2) to facilitate later disassembly.

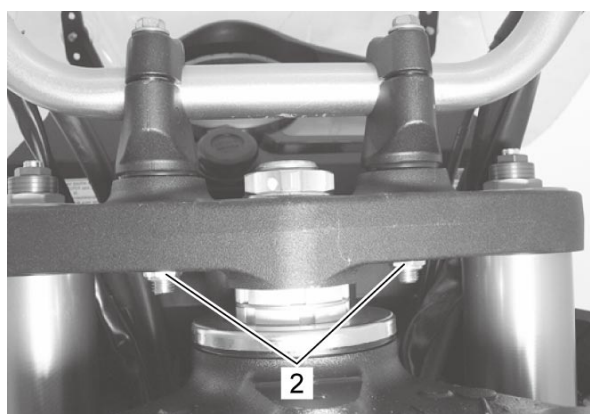
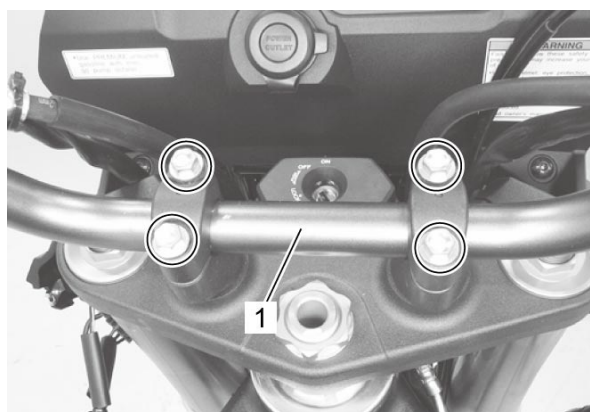



7) Remove the handlebars backward.

NOTE:**Place a rag on the frame to prevent the handlebars scratched.**

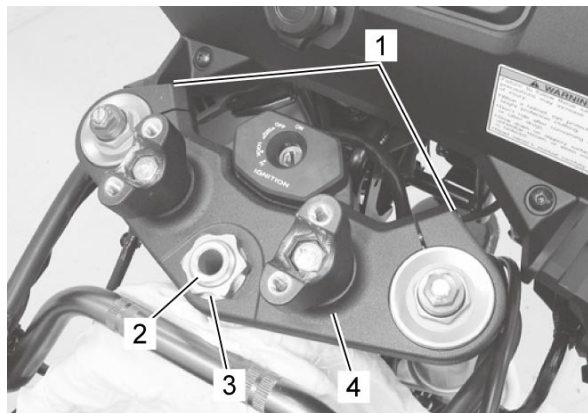
- 8) Loosen the front fork upper clamp bolts (1).
- 9) Remove the steering stem head nut (2), washer (3) and steering stem upper bracket assembly (4).



- 10) Remove the ignition switch and ignition switch cover. 
- 11) Remove the immobilizer antenna. (If equipped) 
- 12) Remove the handlebar holders (1).

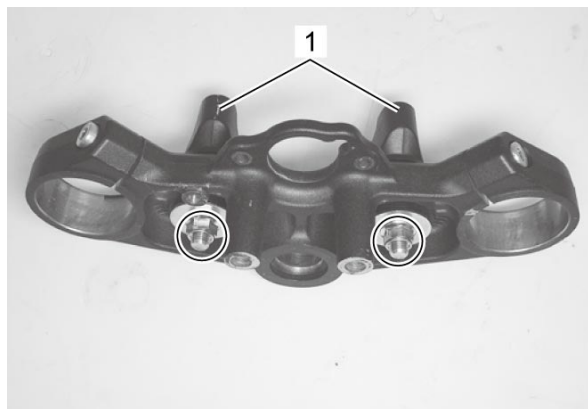

- 13) Remove the following parts from the steering stem upper bracket.
 - Washer (1)
 - Rubber (2)

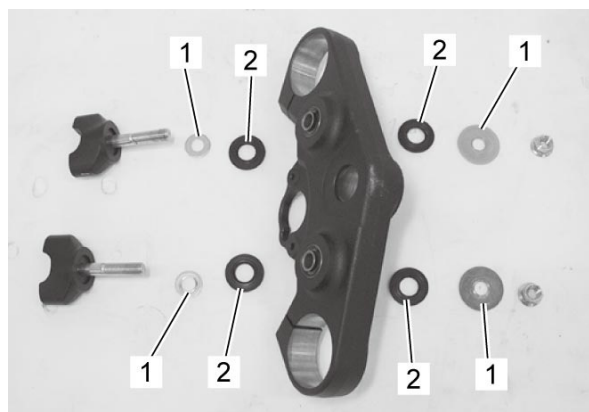

Installation

Reference: Steering Stem Upper Bracket Inspection

1) Install the following parts to the steering stem upper bracket.

- Rubber (1)
- Washer (2)
- Handlebar holder (3)
- Nut (4)

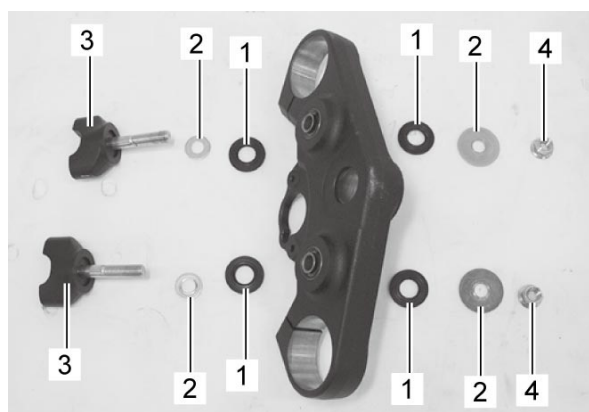

2) Place the handlebar holder at right angles with the steering stem upper bracket (1), then temporarily tighten it.

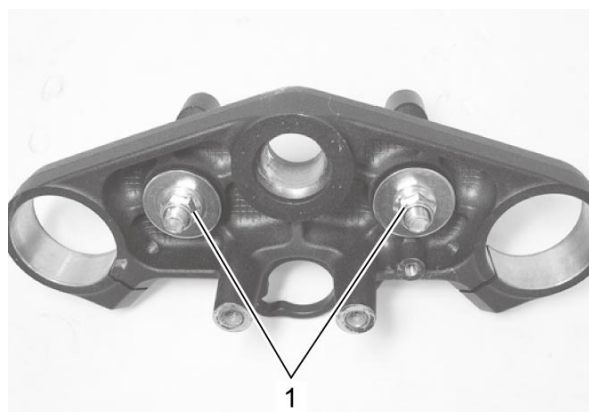



- 3) Install the immobilizer antenna. (If equipped)
- 4) Install the ignition switch and ignition switch cover.
- 5) Install the steering stem upper bracket assembly (1), washer (2) and steering stem head nut (3).
- 6) Tighten the steering stem head nut (3) and front fork upper clamp bolts (4) to the specified torque.

Tightening torque

Steering stem head nut (a): 90 N·m (9.0 kgf-m, 65.0 lbf-ft)

Front fork upper clamp bolt (b): 23 N·m (2.3 kgf-m, 17.0 lbf-ft)

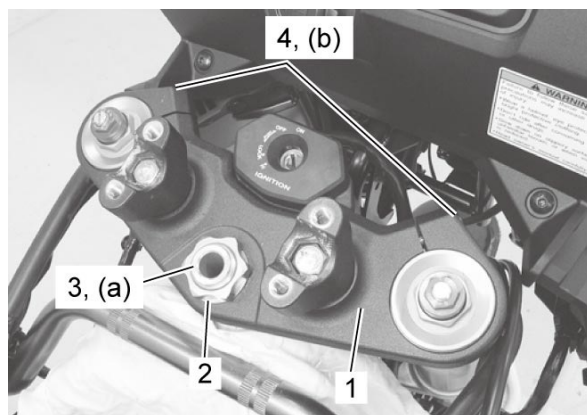

- 7) Install the handlebars.
- 8) Tighten the handlebar holder nuts (1) to the specified torque.

Tightening torque

Handlebar holder nut (a): 45 N·m (4.5 kgf-m, 32.5 lbf-ft)

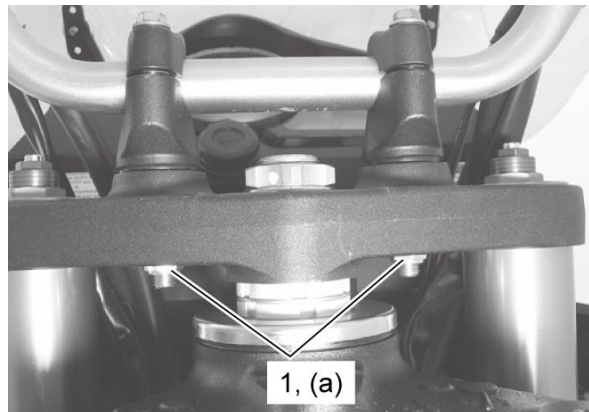

- 9)** Install the guide (1). Refer to [Throttle Cable Routing Diagram](#) and [Front Brake Hose Routing Diagram](#).

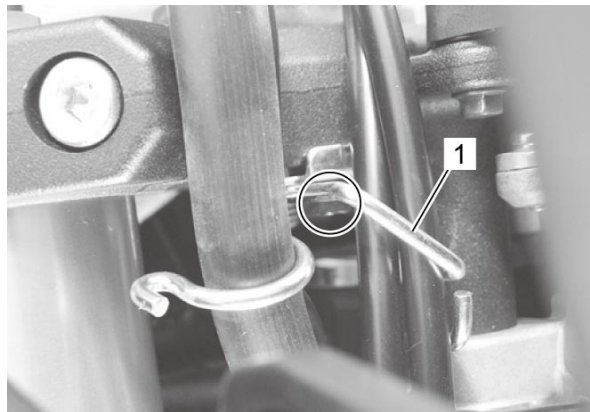

- 10)** Pass the wire harness and connect the clamps (1). 



- 11)** Connect the ignition switch lead wire coupler and immobilizer antenna lead wire coupler. (If equipped)
- 12)** Install the air cleaner box. 